

PATENTS:

2025 3017 3206.3
2025 2074 5333.0
2023 1168 3285.9
2023 2335 0574.5
2020 2310 2170.0
2022 2353 3128.3
2020 3024 4731.7

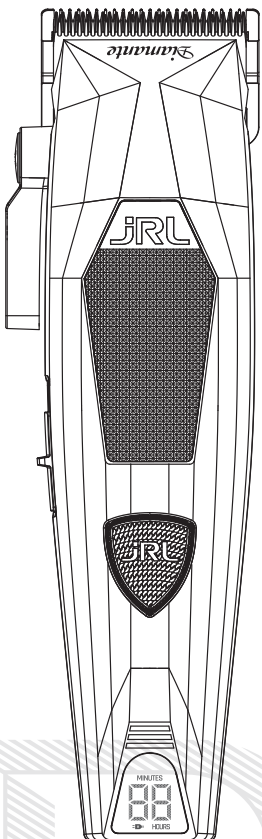

Diamante
2025C
Professional Cordless Hair Clipper

USER'S MANUAL

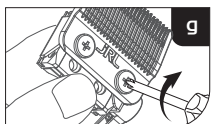
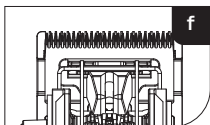
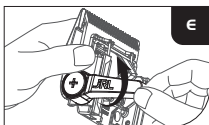
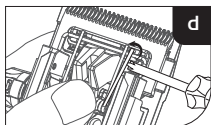
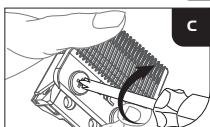
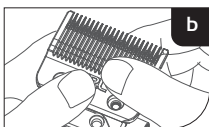
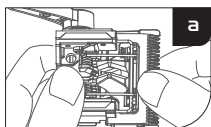
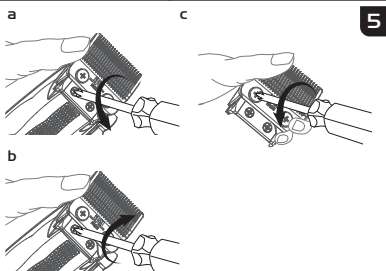
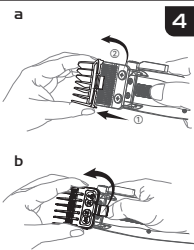
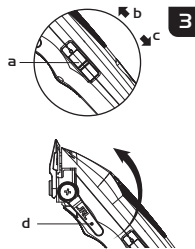
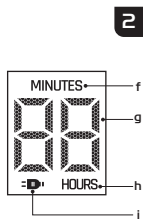
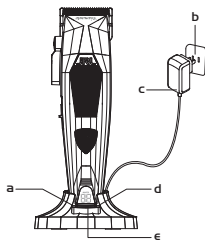
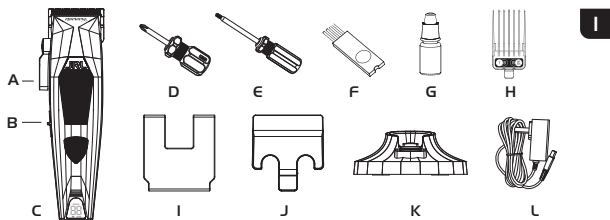

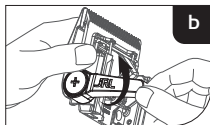
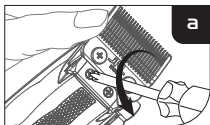
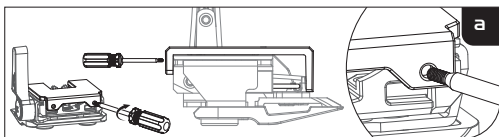
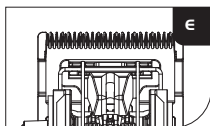
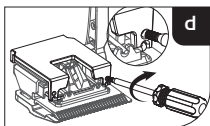
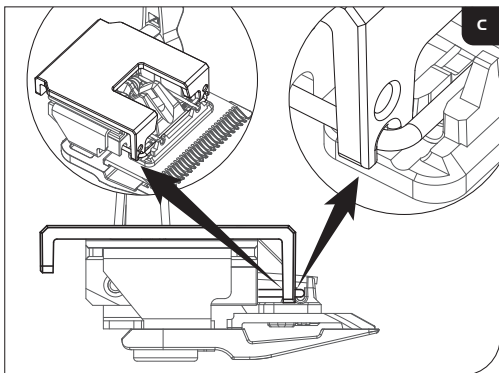
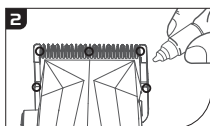
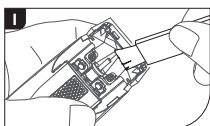
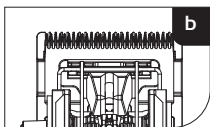
**7****8****9**

Tips

1. This product is designed for professional use only. This machine is not designed to be used on synthetic hair or for any other purpose other than cutting 100% human hair.
2. The company will not take responsibility for malfunctions or damages caused by misuse.
3. The safety instructions and the operating manual are also available in PDF format from our website: www.jrl.com.

Safety precautions

Keep Away from Children:

Please store clipper away from children.

Clipper contains sharp blades and small parts that can be harmful to minors.

Safety Use:

1. This appliance can be used by children aged from 8 years and above and persons with reduced physical, sensory or mental capabilities or lack of experience and knowledge if they have been given supervision or instruction concerning use of the appliance in a safe way and understand the hazards involved.
 2. This appliance is not intended for use by persons (including children) with reduced physical, sensory or mental capabilities, or lack of experience and knowledge, unless they have been given supervision or instruction concerning use of the appliance by a person responsible for their safety.
 3. Children shall not play with the appliance.
 4. Cleaning and user maintenance shall not be made by children without supervision.
 5. The appliance is only to be used with the power supply unit provided with the appliance.
 6. **WARNING:** Keep the appliance dry.
 7. This appliance contains batteries that are non-replaceable.
 8. Unplug the power adapter before cleaning the clipper.
 9. Remove the blade first, then use cleaning brush to remove any hair buildup.
 10. Keep away from water in order to avoid shock or damage to the clipper.
 11. If the clipper is accidentally dropped into water or any other chemicals, discard immediately. Do not try to dry it and plug it into a power source.
 12. To properly store, remove clipper from dock, unplug adapter, and thoroughly clean your unit. Do not store the clipper on the charging dock or leave it attached to the adapter.
 13. If the cord on the power adapter is damaged, stop using it immediately and replace right away.
 14. Do not disassemble this product on your own. Visit authorized dealers for service and repair.
 15. Choose the correct voltage socket before charging (AC100-240V 50/60Hz).
 16. Please do not twist, disassemble or puncture the rechargeable battery within the clipper, otherwise it may cause a short circuit or burn the machine. If the battery is not working, do not run the clipper and take it to an authorized dealer.
 17. Extended use in temperatures below -10°C or above 40°C is not recommended as it may damage the battery.
 18.  detachable power supply part (apply to KA1201A-0502000EU/KA1201A-0502000AU model adapter)
 19. Type of battery: Lithium ion battery
 20. Dispose of used batteries according to local regulations. Do not throw into household waste; use proper recycling or collection points.
 21. Avoid contact with leaking material. If contact occurs, rinse with water and seek medical advice. Use gloves and dispose of safely.
 22. Do not expose the appliance or battery to excessive temperatures
 23. Be aware of the risk of terminals of the battery-operated appliance or battery being short-circuited by metal objects.
- To Avoid Product Damage:**
1. Only use original accessories.
 2. Do not sharpen the blade on your own.
 3. **WARNING:** For the purposes of recharging the battery, only use the detachable supply unit provided with this appliance.

Product overview (Fig.1)

- | | | |
|--------------------------|-----------------------------------|-------------------------|
| A. Blade Adjusting Lever | E. Blade Adjustment Tool | I. Blade Reset Tool |
| B. Power Switch | F. Cleaning Brush | J. Blade Protector |
| C. Clipper Unit | G. Lubricating Oil | K. Reset IQ Charging Do |
| D. Screwdriver | H. Set of 6 Guards (1.5mm – 13mm) | L. Charger Adapter |

Product specifications

Product code: 2025C			
Item	Specifications	Item	Specifications
Power adapter	Input AC 100-240V 50/60Hz	Type of battery	Lithium ion battery
	Output DC 5V 2A	Charging time	2.5 hours for Fast Charging 5 hours for Reset IQ Charge
Battery capacity	3.6V 3400mAh	Usage time	4 hours

The power consumption in another condition mode is 0,33W

When the battery is fully charged, it will immediately enter the off model.

How to charge your clipper

Important: Use only original power cord to charge.

You can charge your unit on the portable charging dock, or charge the clipper directly by plugging the power cord to the clipper itself.(Fig.2b/c)



Note: When the clipper is low on charge, the adapter can be plugged into the clipper directly. You may use the clipper while it is charging.

Reset IQ Technology Charge

Connect charging dock to the power adapter,  green light (Fig.2d) turns on. Using the Reset IQ Charge will extend the life of battery and take about 5 hours to fully charge.

Fast Charging Method

Press the button (Fig.2e)  once on charging dock to switch to fast charge,  white light (Fig.2a) turns on. The set mode rapid Fast Charging Method  takes approximately 2.5 hours.

LED Status Indicators (Fig.f/g/h/i)

- Flashing Light: Clipper is still charging
- Red Light: Less than 40 minutes of battery life remaining
- White Flashing Light: Fast charging in progress (battery above 40 mins)
- Green Flashing Light: Recovery charging in progress (battery above 40 mins)
- Steady White Light: Fully charged

Usage instructions

Switching and shifting instructions:

Push the switch to turn the clipper on and off (Fig.3a/b/c).

By pushing the switch, the speed of the clipper can also be adjusted:

O: Shutdown (off)

I: Speed 1 – 6500 RPM

II: Speed 2 – 8200 RPM

Clipper status indication by LED light:

The battery indicator shows the usable time of the clipper in the current speed setting.

- When the clipper is in high power mode, the  white light is on.
- When the clipper battery is low, the  red light and  the warning light will flash.
- Clipper will automatically turn off all the lights and shut down when the battery is dead.

Adjusting the cutting length

The clipper comes with 5 different adjustment levels, which are: 0.5mm, 1.4mm, 2.0mm, 2.8mm, 3.5mm.

Users can adjust the level according to their needs.

- Push the blade adjustment lever (Fig.3d) forward for a closer cut.
- Push the blade back for the reverse effect.

How to install and replace guards

Clipper comes with 6 guards.

Sizes are: 1/2#(1.5mm), 1#(3mm), 1-1/2#(4.5mm), 2#(6mm), 3#(10mm), 4#(13mm)

Installing your guard:

As shown in the Fig.4a, align the card slot corresponding to the guard with the main unit of the product, and then lift the main unit gently until you hear a 'click', which indicates the installation of the guard is complete.



Note: Before replacing guard, make sure the clipper is turned off.

Make sure the guard is installed properly, and is not loose before use.

Removing your guard:

As shown in the Fig.4b, you can remove the guard by turning the tail of the comb with your finger.

Blade maintenance



- Note:**
1. Please read the blade maintenance Instructions carefully before operating. Follow the instructions when removing and installing the blade to avoid improper assembly.
 2. After the blade is installed, be sure to carefully check whether the corresponding parts have been firmly attached.
 3. Before operating, please unplug the power adapter and turn off the machine.
 4. When handling the blade, do not try to sharpen or alter the blade by yourself to avoid damaging your machine.

How to remove / install the blade set:

- As shown in Fig.5a, hold the clipper with one hand and loosen the screw with a screwdriver to remove the blade assembly.
- Caution: While removing the blade, please hold the blade with the same hand that is holding the main unit to prevent it from falling and getting damaged.)
- As shown in Fig.5b, hold the clipper with one hand, grip the blade with your fingers, and tighten the screw with a screwdriver to install the blade assembly.

Removing the blade:

- Hold the clipper as shown in Fig.5c, loosen the screws shown, and remove the blade. When removing the blade, please hold the blade while holding the clipper to prevent the blade from falling and being damaged (caution: the blade is sharp. Pay attention to protect your hands).

How to install the blade:

1. Install the movable blade on the two pins of the spring attachment (Fig.6a).
2. The lower blade is pressed down firmly and aligned with the bottom screw hole (Fig.6b).
3. Insert the screw clockwise into the 1/3 depth (Fig.6c).
4. If the spring shifts out of the designated slot, please bend it back into the slot (Fig.6d).
5. Set the blade adjustment lever to the foremost position (Fig.6e).
6. Check that upper and lower blades are centered and parallel (Fig.6f).
7. Tighten the screws, and complete the blade assembly (Fig.6g).

How to adjust the blade to 0mm:

1. Remove the blade set (Fig.7a).
2. Move the blade adjustment lever to the foremost position (Fig.7b).
3. Align the two front slots of the blade reset tool flat on top of the blade spring (Fig.7c).
4. Insert the blade reset tool into the front adjustment port of the blade reset tool, and rotate clockwise to set the desired cutting length (Fig.7d).
5. Check the upper and lower blades to ensure they are horizontally centered and that the upper blade does not extend beyond the lower blade (Fig.7e).

How to reset the blade:

1. Remove the blade assembly (Fig.7a).
2. Move the blade adjustment lever to the foremost position (Fig.7b).
3. Place the two front ends of the blade reset tool flat in front of the blade spring. Note: Do not press down on the blade spring (Fig.7c).
4. Insert the blade reset tool into the rear adjustment port of the Bblade reset tool, and rotate clockwise to adjust to the desired cutting length (Fig.8a).
5. Check that the upper and lower blades are horizontally centered, and ensure the upper blade does not extend beyond the lower blade (Fig.8b).

Blade cleaning and maintenance:

- Remove and install blades carefully using the screwdriver provided.
- Clean hair and debris with the brush (Fig.9a).
- Apply lubricant to the five designated blade points (Fig.9b).
- Use the reset tool to adjust or realign blades as needed.
- Always power off and unplug the unit before maintenance.

JRL[®]
PROFESSIONAL

**Guang Zhou Eagle Fortress
Hair Products Ltd.**

No.4 Shuanglong Yucai
Street, Shiling Town, Huadu
District, Guangzhou, 510899
China

Bratt Trading AB

Radiovägen 34
135 48 Tyresö SWEDEN
+46 (8) 712 95 10
info@bratt-trading.se
www.bratt-trading.com



www.jrl.com



www.bratt-trading.com



EAC

**UK
CA**

CE

